

STEEL WATER MANIFOLDS

The only steel manifolds color coded for hot and cold plumbing

LOW COST - ECONOMY MODELS

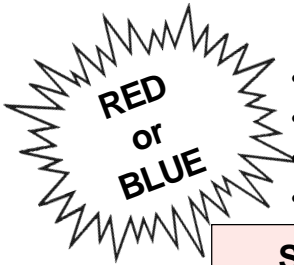

- High quality, robotically welded steel
- Pressure tested by Air @100 psi
- High visibility Red or Blue
- Compact mounting

- 2 Styles available: Straight or Split
- 2" x 2" Steel tubing
- 3/4" NPT Inlet/Outlet main supply
- 1/2" NPT Inlet/Outlet mold supply ports (2-1/2" between centers)

Straight Through

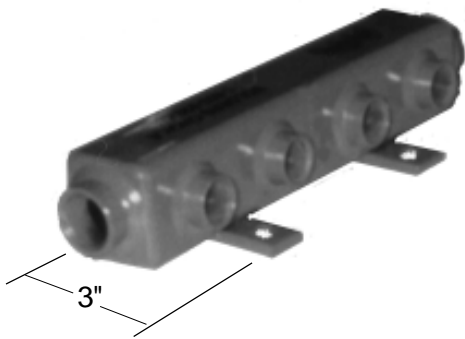

4 Port

Part # **ST4**
\$40.00

OAL: 14"

Add "B" (Blue) or
"R" (Red)
after part number

Split In/Out

RED and BLUE



4 Port

(2 in - 2 out)

Part # **SP422**
\$47.00

OAL: 14"

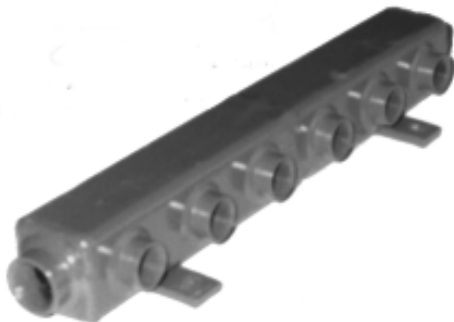

6 Port

Part # **ST6**
\$47.00

OAL: 20"

Add "B" (Blue) or
"R" (Red)
after part number



6 Port

(3 in - 3 out)

Part # **SP633**
\$55.00

OAL: 20"



8 Port

Part # **ST8**
\$59.00

OAL: 26"

Add "B" (Blue) or
"R" (Red)
after part number



8 Port

(4 in - 4 out)

Part # **SPL844**
\$63.00

OAL: 26"

© 2009 MOLDERS CHOICE, Inc.



24 Hour Service - 7 Days a week
1-800-809-4623
WebSite: www.molderschoice.com • Email: molders@molderschoice.com

CUSTOM MANIFOLDS

Custom manifolds made to ORDER in 7 days
Below are a few of the hundreds of variations
made for Customer's World Wide.

Call, Fax or E-mail us your requirements for a quick QUOTE!

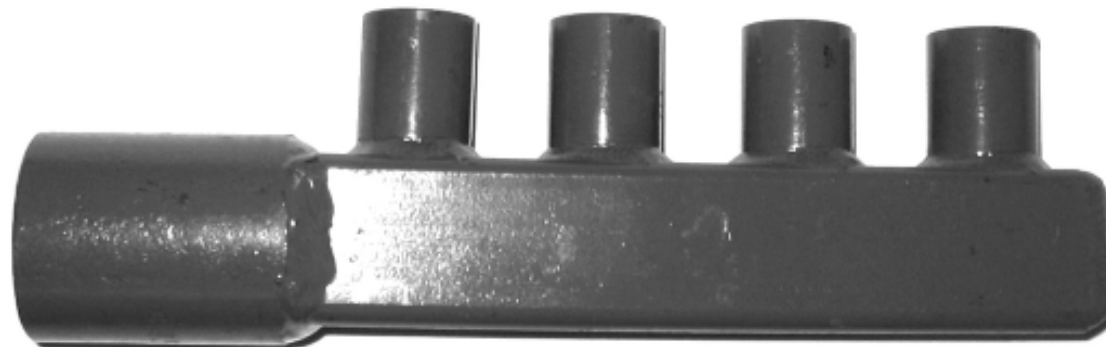
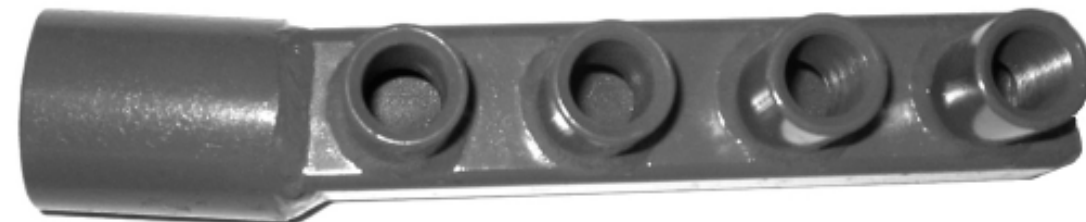

© 2009 MOLDERS CHOICE, Inc.



24 Hour Service - 7 Days a week

1-800-809-4623

WebSite:www.molderschoice.com

E-mail:molders@molderschoice.com