

METRIC CENTER - PULL HOIST RING

Safe Mold Lifting at any angle

Full 360° Swivel
Full 180° Pivot

Quality Standards

- All hoist ring assemblies are pull-tested and certified to 200% of rated load capacity and stamped with identifying date code.
- All hoist rings are designed for 5:1 strength factor.
- Finished assembly is black-oxide plated (with the exception of the washer).
- Individual certificate of proof-test accompanies product in final packaging.



SPECIFICATIONS

- Material: 4140
- Finish: Black Oxide
- Clevis, Bolt, Pins, Base, Washer and Bushing are magnetic-particle inspected based on ASTM709-80 and MIL-STD-105
- Washer: Zin Plated Silver
- 200% Proof Tested

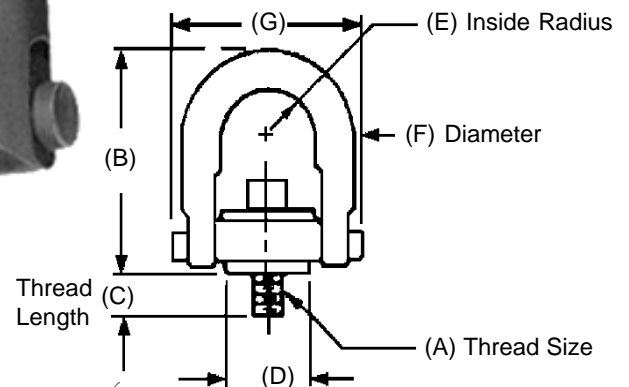

| THRD SIZE A | LOAD CAP (lbs) | PART # | THREAD LENGTH | | | | | | TORQUE (ft.-lbs.) | WT. (lbs.) | PRICE |
|-------------------|----------------------|--------------|---------------|-------|------|------|-------|-------|----------------------|---------------|------------------|
| | | | B | C | D | E | F | G | | | |
| M8X1.25 | 400 | 23456 | 67.8 | 12.5 | 19 | 10.9 | 9.7 | 46.7 | 1 | 0.17 | \$50.00 |
| M10X1.5 | 450 | 23458 | 67.8 | 17.5 | 19 | 10.9 | 9.7 | 46.7 | 1.7 | 0.17 | \$50.00 |
| M12X1.75 | 1050 | 23462 | 170 | 19 | 1.50 | 22.4 | 19 | 89.4 | 3.8 | 1.08 | \$60.00 |
| M16X20 | 1900 | 23465 | 121.4 | 29 | 1.50 | 22.4 | 19 | 89.4 | 8.2 | 1.12 | \$60.00 |
| M20X2.5 | 2150 | 23468 | 121.4 | 34 | 1.50 | 22.4 | 19 | 89.4 | 13.6 | 1.19 | \$6.000 |
| M20X2.5 | 3000 | 23471 | 165.6 | 32 | 1.50 | 35.6 | 25.4 | 130.6 | 13.6 | 3.03 | \$130.00 |
| M24X3.0 | 4200 | 23474 | 165.6 | 37 | 1.50 | 35.6 | 25.4 | 130.6 | 31 | 3.1 | \$130.00 |
| M30X3.5 | 7000 | 23478 | 221.7 | 41.9 | 1.50 | 44.5 | 31.7 | 165.1 | 60 | 6.3 | \$220.00 |
| M30X3.5 | 7000 | 23479 | 221.7 | 61.7 | 2.31 | 44.5 | 31.7 | 165.1 | 60 | 6.4 | \$220.00 |
| M36X4.0 | 11000 | 23483 | 316.7 | 63.5 | 2.31 | 57.2 | 44.4 | 217.2 | 100 | 15.5 | \$408.00 |
| M42X4.5 | 12500 | 23484 | 316.7 | 68 | 2.31 | 57.2 | 44.4 | 217.2 | 100 | 16 | \$476.00 |
| M48X5.0 | 13500 | 23485 | 316.7 | 82.4 | 3.19 | 57.2 | 44.4 | 217.2 | 100 | 16.8 | \$502.00 |
| M64X6.0 | 22500 | 23488 | 419.1 | 101.6 | 4.19 | 76.2 | 57.15 | 297.6 | 209 | 40 | \$1321.00 |

© 2009 MOLDERS CHOICE, Inc.



24 Hour Service - 7 Days a week

1-800-809-4623

WebSite: www.molderschoice.com • Email: modlers@molderschoice.com