

# CENTER - PULL HOIST RING

*Safe Mold Lifting at any angle*

**Full 360° Swivel**  
**Full 180° Pivot**

**Quality Standards**

- All hoist ring assemblies are pull-tested and certified to 200% of rated load capacity and stamped with identifying date code.
- All hoist rings are designed for 5:1 strength factor.
- Finished assembly is black-oxide plated (with the exception of the washer).
- Individual certificate of proof-test accompanies product in final packaging.



**SPECIFICATIONS**

- Material: Alloy Steel
- Finish: Black Oxide
- Clevis, Bolt, Pins, Base, Washer and Bushing are magnetic-particle inspected based on ASTM709-80 and MIL-STD-105
- Washer: Gold Iridite
- 200% Proof Tested

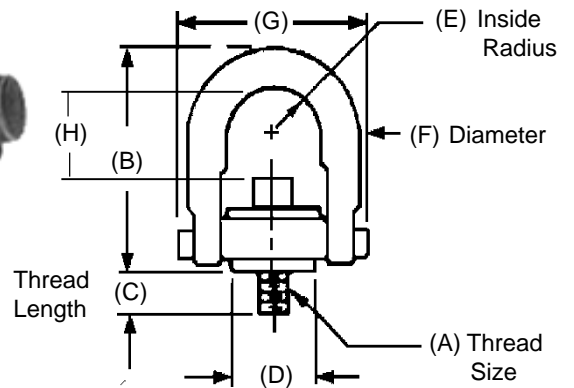

THRD SIZE A	LOAD CAP (lbs)	PART #	THREAD LENGTH							TORQUE (ft.-lbs.)	WT. (lbs.)	PRICE
			B	C	D	E	F	G	H			
5/16-18	800	23406	2.67	9/16	.75	.43	.38	1.84	1-1/4	7	.3	\$49.00
3/8-16	1000	23408	2.67	9/16	.75	.43	.38	1.84	1-1/4	12	.3	\$49.00
1/2-13	2500	23412	4.78	1	1.50	.88	.75	3.52	2-3/8	28	2.5	\$57.00
1/2-13	2500	23413	4.78	1-1/4	1.50	.88	.75	3.52	2-3/8	28	2.5	\$59.00
5/8-11	4000	23414	4.78	1	1.50	.88	.75	3.52	2-1/4	60	2.7	\$59.00
5/8-11	4000	23415	4.78	1-1/4	1.50	.88	.75	3.52	2-1/4	60	2.7	\$59.00
3/4-10	5000	23417	4.78	1	1.50	.88	.75	3.52	2-1/8	100	3.0	\$59.00
3/4-10	5000	23418	4.78	1-1/2	1.50	.88	.75	3.52	2-1/8	100	3.0	\$59.00
7/8-9	8000	23424	6.52	1-1/4	2.31	1.40	1.00	5.14	2-13/16	160	7.5	\$132.00
1-8	10000	23425	6.52	1-1/4	2.31	1.40	1.00	5.14	2-11/16	230	7.5	\$132.00
1-8	10000	23426	6.52	1-1/2	2.31	1.40	1.00	5.14	2-11/16	230	7.5	\$132.00
1-1/4-7	15000	23429	8.73	1-7/8	3.19	1.75	1.25	6.50	4-1/4	470	14	\$220.00
1-1/2-6	24000	23433	12.47	2-3/4	4.19	2.25	1.75	8.55	6-1/2	800	33	\$300.00

**Metric sizes available . . . SEE PAGE 205**

© 2009 MOLDERS CHOICE, Inc.



**24 Hour Service - 7 Days a week**  
**1-800-809-4623**  
WebSite: [www.molderschoice.com](http://www.molderschoice.com) • Email: [molders@molderschoice.com](mailto:molders@molderschoice.com)