

EYE BOLTS

SUPERIOR QUALITY • MADE IN USA • PRICED RIGHT

Plain Pattern

• Forged • 1030 Carbon Steel • Self-Colored

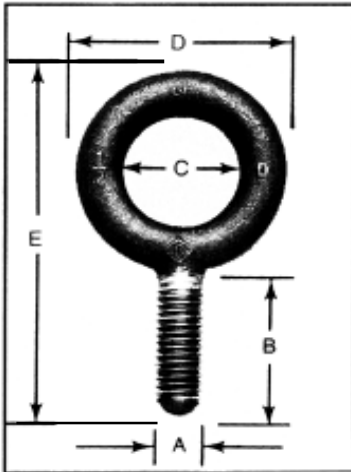

PART #	THREAD SIZE UNC-2A A	SHANK LENGTH B	EYE I.D. C	EYE O.D. D	OVERALL LENGTH E	RATED CAPACITY LBS.	PRICE
13631	3/8-16	1-1/4"	1"	1-11/16"	3"	1,300	\$2.70
13638	7/16-14	1-3/8"	1-3/32"	1-13/16"	3-7/32"	1,800	\$3.20
13641	1/2-13	1-1/2"	1-3/16"	2-1/8"	3-21/32"	2,400	\$3.00
13661	5/8-11	1-3/4"	1-3/8"	2-9/16"	4-3/8"	4,000	\$4.80
13672	3/4-10	2"	1-1/2"	2-13/16"	4-7/8"	5,000	\$6.00
13682	7/8-9	2-1/4"	1-11/16"	3-3/16"	5-1/2"	7,000	\$7.60
13702	1-8	2-1/2"	1-13/16"	3-9/16"	6-1/8"	9,000	\$8.66
13712	1-1/8-7	2-3/4"	2"	4-1/16"	6-7/8"	12,000	\$16.00

Shoulder Pattern

• Forged • 1030 Carbon Steel • Self-Colored

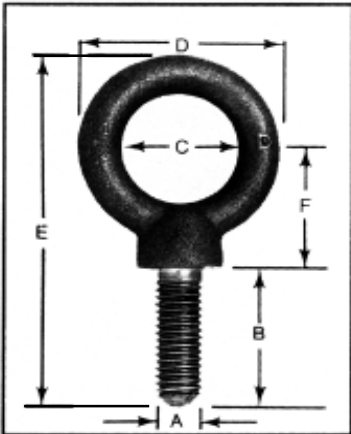

PART #	THREAD SIZE UNC-2A A	SHANK LENGTH B	EYE I.D. C	EYE O.D. D	OVERALL LENGTH E	CENTER OF EYE TO SHOULDER F	RATED CAPACITY LBS.	PRICE
14631	3/8-16	1-1/4"	1"	1-11/16"	3-1/4"	1-1/8"	1,300	\$2.65
14638	7/16-14	1-3/8"	1-3/32"	1-13/16"	3-9/16"	1-1/4"	1,800	\$3.20
14641	1/2-13	1-1/2"	1-3/16"	2-1/8"	3-31/32"	1-3/8"	2,400	\$3.30
14661	5/8-11	1-3/4"	1-3/8"	2-9/16"	4-3/4"	1-21/32"	4,000	\$4.80
14672	3/4-10	2"	1-1/2"	2-13/16"	5-1/4"	1-13/16"	5,000	\$6.00
14682	7/8-9	2-1/4"	1-11/16"	3-3/16"	6"	2-1/8"	7,000	\$8.10
14702	1-8	2-1/2"	1-13/16"	3-9/16"	6-5/8"	2-5/16"	9,000	\$8.66
14712	1-1/8-7	2-3/4"	2"	4-1/16"	7-17/32"	2-11/16"	12,000	\$14.50

Metric Shoulder Pattern

• Forged • 1030 Carbon Steel • Self-Colored • Shoulder Pattern

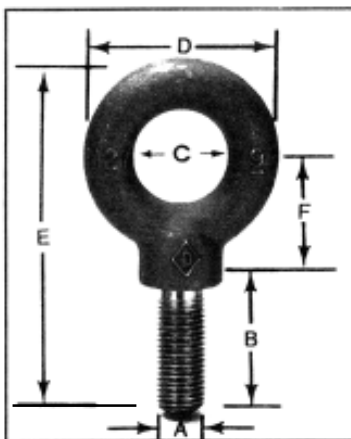

PART #	APPROX EQUIVA- LENT IN INCHES	THREAD SIZE A	SHANK LENGTH B	EYE I.D. C	EYE O.D. D	OVERALL LENGTH E	CENTER OF EYE TO SHOULDER F	RATED CAPACITY (KGS)	PRICE
14638M	7/16	M10 x1.5	35.0mm	27mm	46.0mm	90.5mm	30.9mm	740	\$4.08
14641M	1/2	M12 x1.75	38.0mm	30mm	54.0mm	100.8mm	34.0mm	1,030	\$4.80
14661M	9/16	M14 x2.0	44.5mm	35mm	65.0mm	120.7mm	40.9mm	1,600	\$6.00
14662M	5/8	M16 x2.0	44.5mm	35mm	65.0mm	120.7mm	40.9mm	1,600	\$6.70
14672M	3/4	M18 x2.5	51.0mm	38mm	71.5mm	133.3mm	44.7mm	2,140	\$8.50
14682M	7/8	M20 x2.5	57.0mm	41mm	81.0mm	152.4mm	52.5mm	2,860	\$11.50

© 2009 MOLDERS CHOICE, Inc.



24 Hour Service - 7 Days a week

1-800-809-4623

WebSite: www.molderschoice.com • Email: molders@molderschoice.com