

NOZZLE TIPS

Reduce Nozzle costs and increase flexibility



2 Choices of materials

- **Chrome Vanadium Tungsten tool steel:**
 - Exceptional toughness and impact strength
 - Superior wear resistance
 - Resistance to high temperature fatigue
- **Beryllium Copper:**
 - Reduces tip freeze-offs
 - Eliminates stringing problems

Replace only the tip for:

- Longer lengths for recessed sprue bushings
- Orifice size to reduce pressure drop at nozzle
- When radius is worn or damaged
- Internal design matching your type of plastic material

Available in 3 Internal Designs

GENERAL PURPOSE
(Straight Bore)

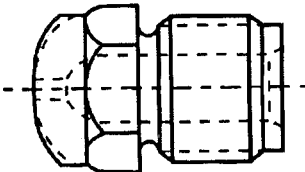

For all general purpose materials;
i.e. styrene, polyethylene, polypropylene etc.

NYLON
(Reverse Taper)

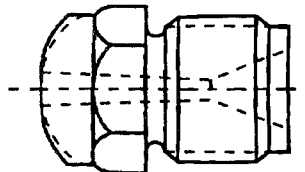

Reduces drool when
processing nylon.

FULL TAPER

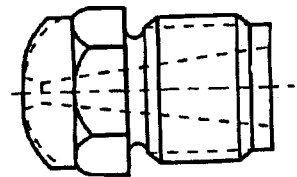

For use with ABS, PVC, acrylics
and other engineering materials.



© 2009 MOLDERS CHOICE, Inc.

24 Hour Service - 7 Days a week
1-800-809-4623
 WebSite: www.molderschoice.com • Email: molders@molderschoice.com

TOOL STEEL or COPPER NICKEL NOZZLE TIPS

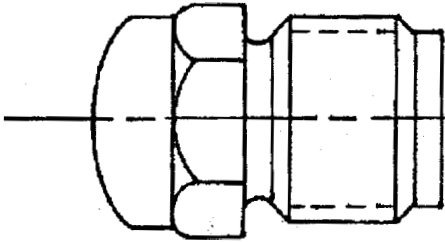
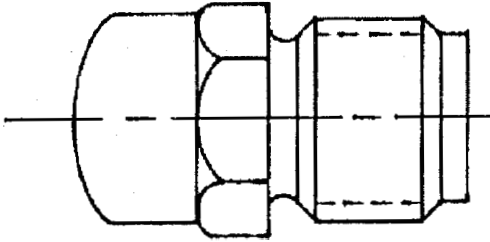
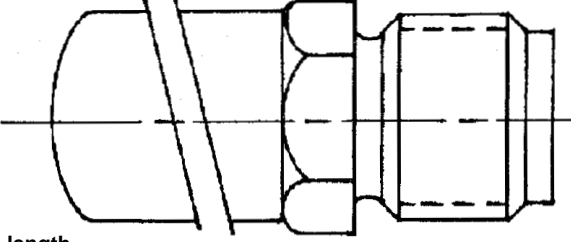
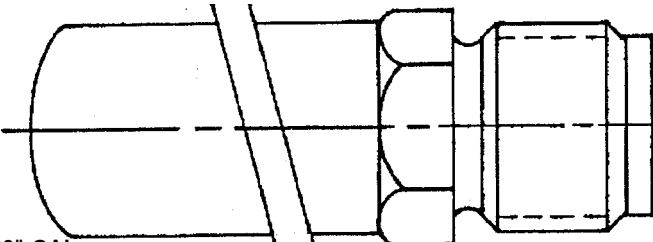
| | | | | | | | |
|---|--|---|--|---|--|--|--|
|  <p>1-1/2" OAL Adds 3/4" to body length</p> |  <p>2.75" OAL Adds 2" to body length Takes Standard or Keylock 1"x1" Heater Band</p> |  <p>4" OAL Adds 3-1/4" to body length Takes Standard or Keylock 1"x36" Heater Band</p> |  <p>6.00" OAL Adds 5.25" to body length Takes Standard or Keylock 1"x 4" Heater Band</p> | <p style="text-align: center;">Tool Steel</p> <p>General Purpose (GP) \$13.50 Nylon (N) \$18.50 Full Taper (FT) \$20.00</p> <p style="text-align: center;">Beryllium Copper</p> <p>General Purpose (GPBC) \$25.00 Nylon (NBC) \$26.00 Full Taper (FTBC) \$26.00</p> | <p style="text-align: center;">Tool Steel</p> <p>General Purpose (GP) \$37.00 Nylon (N) \$37.00 Full Taper (FT) N/A</p> <p style="text-align: center;">Beryllium Copper</p> <p>General Purpose (GPBC) \$50.00 Nylon (NBC) \$50.00</p> | <p style="text-align: center;">Tool Steel</p> <p>General Purpose (GP) \$39.00 Nylon (N) \$39.00 Full Taper (FT) N/A</p> <p style="text-align: center;">Beryllium Copper</p> <p>General Purpose (GPBC) \$67.00 Nylon (NBC) \$67.00</p> | <p style="text-align: center;">Tool Steel</p> <p>General Purpose (GP) \$51.00 Nylon (N) \$51.00 Full Taper (FT) N/A</p> <p style="text-align: center;">Beryllium Copper</p> <p>General Purpose (GPBC) \$81.00 Nylon (NBC) \$81.00</p> |
| Standard 7/8"-14 Thread, 1/2" R.O. | | | | | | | |

Ordering Information

For short 1-1/2" tips

| | | | | | |
|------|-----|------|----------------|--------------|--|
| GP | N | FT | | | |
| GPBC | NBC | FTBC | | | |
| | | | Radius | | |
| | | | 1/2" : 5 | | |
| | | | 3/4" : 7 | | |
| | | | Orifice | | |
| | | | 1/16" : .062 | 7/32" : .218 | |
| | | | 1/8" : .125 | 1/4" : .250 | |
| | | | 5/32" : .156 | 5/16" : .312 | |
| | | | 3/16" : .187 | 3/8" : .375 | |

For 2.75", 3.75" & 5" long tips

| | | | | | |
|----|---|------|----------------|--------------|--|
| GP | N | GPBC | NBC | | |
| | | | Radius | | |
| | | | 1/2" : 5 | | |
| | | | 3/4" : 7 | | |
| | | | Orifice | | |
| | | | 1/16" : .062 | 7/32" : .218 | |
| | | | 1/8" : .125 | 1/4" : .250 | |
| | | | 5/32" : .156 | 5/16" : .312 | |
| | | | 3/16" : .187 | 3/8" : .375 | |

© 2009 MOLDERS CHOICE, Inc.



24 Hour Service - 7 Days a week

1-800-809-4623

WebSite: www.molderschoice.com • Email: moders@molderschoice.com

OEM - Replacement NOZZLE TIPS

Unusual Tips for Foreign Presses

Why pay the OEM top dollar for oddball tips?

Get Top-Quality Nozzle Tips at MOLDERS CHOICE Prices.

Arburg

Demag

Engel

Klockner

Nissei

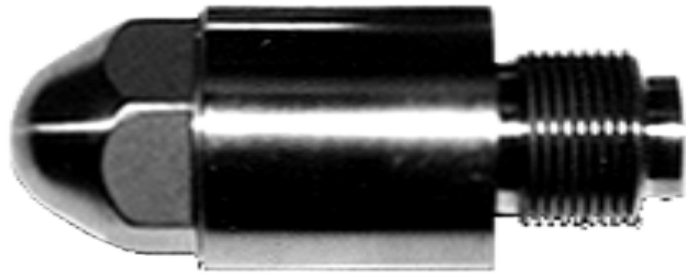

(Nissei 20 mm thread shown)

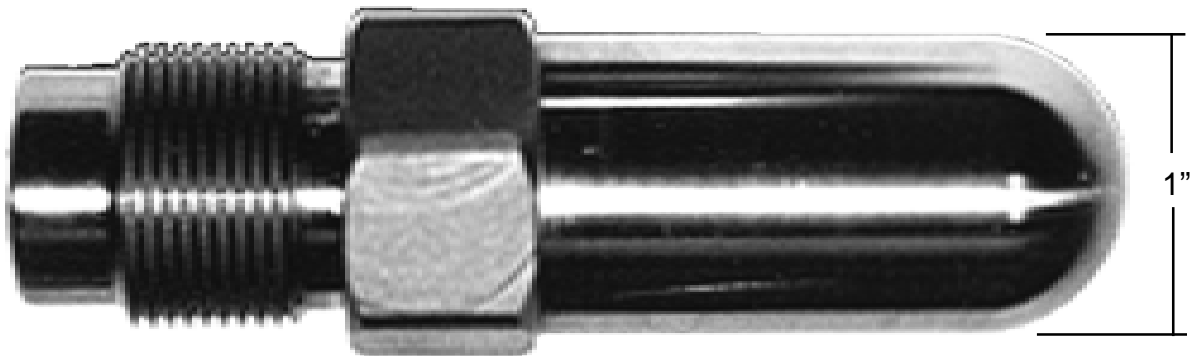

(Arburg 25 mm thread shown)

Call for dimensions, price and delivery



© 2009 MOLDERS CHOICE, Inc.

24 Hour Service - 7 Days a week

1-800-809-4623

WebSite: www.molderschoice.com • Email: molders@molderschoice.com